

36" Basket Fan



Assembly and operating instructions

CAUTION: Read and follow all instructions before operating fan. Do not use fan if any part is damaged or missing.

WARNING: To reduce the risk of fire or electrical shock, do not expose to water or rain. TO reduce the risk of electrical shock, do not use this fan with any solid state speed control device.

RULES FOR SAFE OPERATION

- The fan needs to be mounted a min. 2.4m from floor and the guard is not OSHA guard.
- Never insert fingers or any other objects through the grill guard when fan is in operation.
- Unplug the fan when moving from one location to another.
- Unplug the fan when removing guards for cleaning.
- DO NOT use with an extension cord.
- DO NOT place fan or any parts near an open flame, or other heating appliance.
- Be sure the fan is securely mounted on the mounting bracket.
- DO NOT use fan in a humid environment. Rain and other moisture may create electrical hazard.
- AT ANY TIME this unit is not used by or near children.
- All electrical work must be done by a licensed electrician in accordance with all applicable electrical codes.

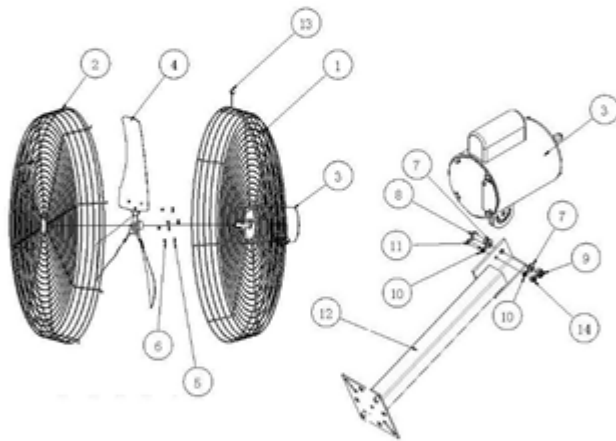

Item	Desc	qnty
1	Rear guard	1
2	Front guard	1
3	Motor	1
4	Blade	1
5	Washer	4
6	Locking nut	4
7	Washer	2
8	10*30 bolt	1
9	Locking nut	1
10	Washer	2
11	6*30 bolt	1
12	Bracket	1
13	Cable tie	4
14	Locking nut	1

Fig. 1 Fan guards

Fig. 2 Mounting bracket

Fan Assembly

1. Place 36" basket fan Rear Guard (1) over studs on motor (3). then place the 4 Washer C6*20 (5) over the studs, followed by the 4 10-24* Locking nut (6). Tighten down the 4 nuts firmly.
2. Place the blade (4) on the motor shaft with the set screws facing in toward the motor. Slide the blade on the shaft so it is flush with the end of the shaft. Align the set screws with the flat portion of the shaft and tighten set screws.
3. Take the basket fan 36 Front Guard (2) and place it on the basket fan 36 Rear Guard (1). Slide over all hooks. The remainder of the hooks can be forced in using a flat blade screw driver. Be very careful not to pinch your fingers!
4. Your fan is now assembled. We suggest Placing the 4 provided nylon cable tie 8*250 (13) around the last ring of the front and rear guards to help isolate any vibrations.

36" Basket Fan



Fig. 3 Fan assembly

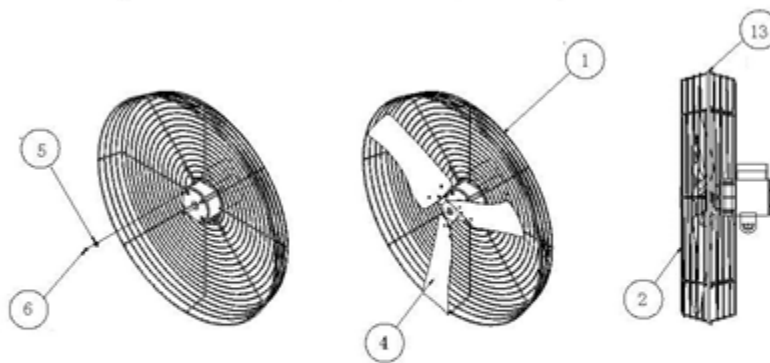

Bracket and Mounting

1. Find a solid place to mount your basket fan. Look for rafters, I-beams, or floor joists.
2. Please note the orientation of the bracket in the diagrams for optimum adjust ability. See fig. 4
3. Secure the fan head to the bracket using the hardware provided. See fig. 2
4. If the specific motor your fan was supplied with has a drain plug, you should remove the bottom plug closest to the motor shaft.
5. If the specific motor your fan was supplied with does not come pre-wired, you are now ready for wiring. We recommend that you always use a licensed electrician. You need to have a disconnect or switch close to the fan for safety.
6. Before starting the fan for the first time. Make sure that all mounting hardware is tight Also check the fan blade for tip clearance.

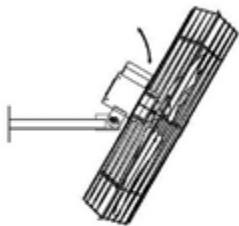

Fig. 4

Fan and bracket must be positioned in this way to allow fan to be pivoted downward to direct the air flow.]

Maintenance

It is very important for the life of the fan that it is kept free of dust and dirt build up. The motor is a sealed air over motor, so it needs to be free of build up for cooling purposes. There is no additional maintenance needed.

36" Basket Fan



Wiring

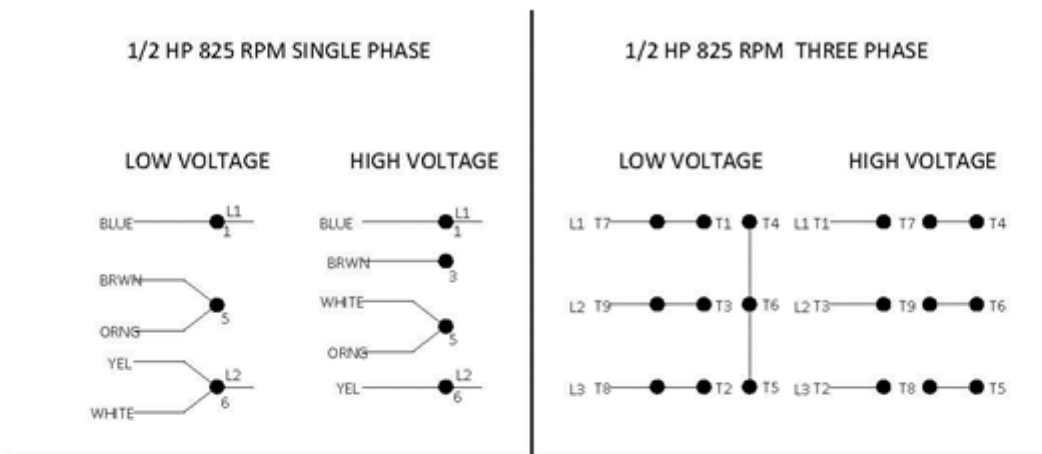

Warranty

VES-Artex warrants every new fan to be free of defects and workmanship to the extent that, within 2-year from the date of purchase VES-Artex shall either repair or replace at their option, any unit or part thereof, returned to VES-Artex freight per-paid and found to be defective. A return authorization must be obtained prior to any warranty work and a proof of purchase may be required.

This warranty does not include any labor or transportation cost incidental to the removal and reinstallation of the unit at the user's premises. Components repaired or replaced are warranted through the remainder of the original warranty period only. This warranty applies to the original purchaser-user only. Purchaser is responsible for and shall maintain and use the equipment pursuant to VES-Aertex's recommendations. No parts will be covered due to the neglect of maintenance on equipment, nor due to electrical surges or lightning or other acts of nature. The purchaser shall hold VES-Artex harmless from any claim or loss. Claims may be filed under this warranty and obligations to make repairs shall begin only after the product is paid. This warranty does not cover loss of time, inconvenience, and loss of revenue, livestock, poultry, or other consequential damages of any kind. The limited warranty is given in partial consideration of the time of purchase and is the only warranty offered. There shall be no other warranty either expressed or implied which apply to this purchase.

Contact

Please contact VES-Artex with any questions.